

The Living Churchyard of St. Michael and St. Mary Magdalene.

Top Ten Facts

- Easthampstead is Saxon for a homestead near a slow stream or may mean Farm of Lachen.
- The ancient Yew tree may indicate that this was a site of Pre Christian worship.
- The oldest graves date from the 18th century and are on the south side of the Parish Church.
- The lower half of the Tower dates from 1660, the upper half from 1873. The Tower is 76 ft (25 m) high to the parapet and 82 ft (27 m) high to the weathervane.
- The Churchyard closed to new burials in 1975 and maintained is by Bracknell Forest Borough Council.
- The Churchyard is one of the few unchanged natural sites since the development of Bracknell in the 1960's.

- The grass is kept long and cut in rotation to encourage a biodiversity of plant and wildlife.
- Volunteers monitor the plant and animal life. Evening Bat walks are held regularly.
- The rare Devil's Bit Scabious, Cowslips, Holly Butterflies and Stag Beetles are found here.
- Bird boxes and Bat roosts are sited in the trees.

Top Sights

The explanation to the numbers on the plan are overleaf. Some of the sights aren't easy to find but exploring is part of the fun.

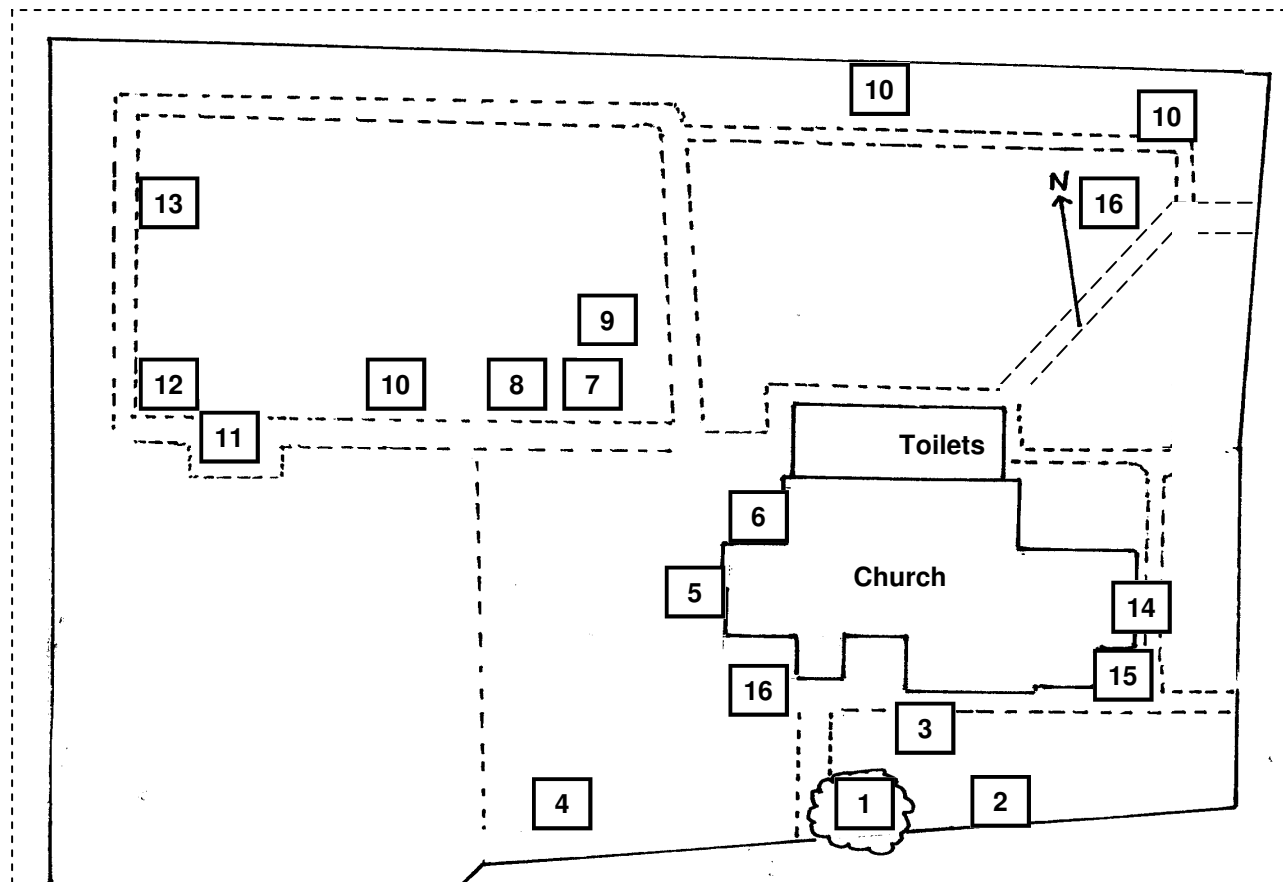

Where are the toilets?

Toilets, including a disabled toilet and baby-changing facilities, are available in the Annexe.

Can I get something to eat and drink?

Light refreshments are available in the Annexe during Heritage Open Week.

Is there anything for the children?

Children's craft activities are available in the Annexe during Heritage Open Week. There is also a Children's Church Trail Leaflet available from the Church Welcomers.

Can I buy a Guide Book?

A Church Guide Book, a Guide to the Windows, a History of Easthampstead and postcards are all available for sale. You can also ask the Church Welcomers to see the Heritage Resource Files which have detailed information.

Are there Guided Tours?

The Church Welcomers will always be glad to answer your questions. There are also guided tours of the Tower and Churchyard at advertised times in Heritage Open Week.

What times are the Services?

Our main service on a Sunday is at 9.30am when there is also Junior Church for the children.

For Heritage Open Week there is a special Choral Service on Sunday 13th September at 6pm.

1 The Ancient Yew Tree

A constant feature of the Churchyard for over 1000 years. It may be evidence of a Pre Christian sanctuary on this hill.

2 William Lawrence's Table Tomb

The oldest memorial in the Churchyard is the Table Tomb, nearest the notice board, dating from 1727. Before the 18th century it was rare for graves to be marked. Of the 1000s of people who are buried in the Churchyard most lie in unmarked graves.

3 Revd Abraham Boyle Townsend

Rector of the Old Church for 34 years from 1826 -1860. The first known Rector was Adam de Budham 1298-1305.

4 John Thaddeus Delane

The railed grave nearest the Bus Stop is that of John Thaddeus Delane. He was Editor of *The Times* in the 1850s. Delane established the reputation of the newspaper and wrote a code of professional conduct for journalists which is still used today.

5 The Tower

A stone inscribed "Henry Boyer 1664" is on the right buttress. The base of the tower dates from the 1660s and was heightened in 1873. The change in the colour and texture of the bricks half way up is where the old tower joins the 19th century addition.

6 Georgine Samuel

Georgine was the young daughter a German Jewish émigré. The stained glass window behind is in her memory. Note the blocked 17th century window in the tower to the right.

7 Revd Osborn Gordon

Rector for 23 years, from 1860-83, who was responsible for the rebuilding of the Old Church. A scholar, mountaineer and friend of the Pre-Raphaelite artists who preached at the Duke of Wellington's funeral in St Paul's Cathedral on 20 November 1852.

8 Canon Herbert Salway

Gordon's successor as Rector for 37 years from 1883-1921. He wrote the first History of Easthampstead Church and Park.

9 The Hayter and Haversham Graves

Both these families lived at South Hill Park. Sir William Hayter was a churchwarden and friend of Gordon's who oversaw the rebuilding of the Church. Sir William's butler discovered him drowned in South Hill Park lake on Boxing Day 1878.

10 The Commonwealth War Graves

Most soldiers who died in WW1 were buried at the Front. These soldiers died of their wounds in Church Hill House Hospital opposite the Church.

11 The War Memorial

It remembers the 65 men of Easthampstead who died in WW1 but not the 9 men who died in WW2. It was designed by Temple Moore, a famous architect of the Arts and Crafts Movement, in 1920.

12 Lord Arthur Hill

Hill is the family name of the Marquises of Downshire who owned Easthampstead Park and whose family Church this was. Lord Arthur Hill was the 2nd son of the 4th Marquis.

13 Fredrick Jackson

A famous Victorian Polar explorer who rescued Dr Nansen's ill-fated expedition. He also discovered Franz Joseph Land, an arctic island group north of Russia. His gravestone is shaped like an iceberg. He has a memorial in St Paul's Cathedral.

14 The Foundation Stone

This was laid in 1865 when the Church was rebuilt. It is at ground level in the middle of the East Wall. The ashes of Revd Alan Christmas, Rector 1985-88, a pioneer of Industrial chaplaincy, lie here.

15 Lady Annie Hill

There are several Hill family graves in the Churchyard. Lady Annie Hill was the wife of Lord Arthur Hill [9]

16 The Living Churchyard Notice Boards

Please read the notice boards which explain the aims and work of our award-winning Living Churchyard scheme. If you would like to become involved please ask a Church Welcomer for details.

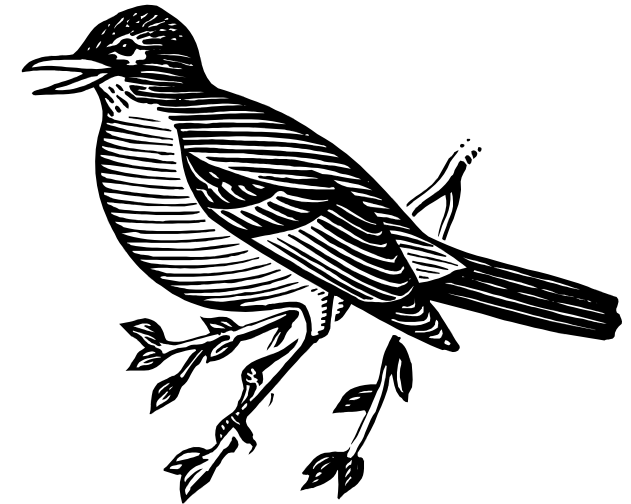

Welcome to

**The Living Churchyard
of St Michael and
St Mary Magdalene
Easthampstead**

We hope the information and plan
in this leaflet will help you make the
most of your visit